

Accessories

■ **NSL25** Arc catcher

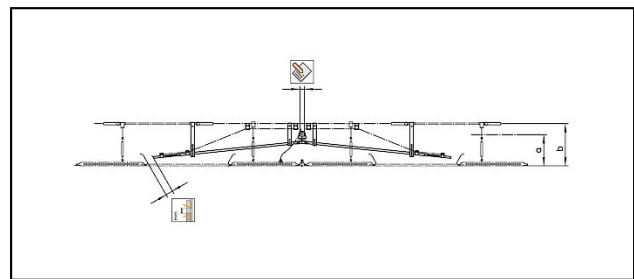



Application
The arc catcher is a mounted device for the Neutral Section / Phase Break NS 25.

Characteristics
The arc catcher is used on Neutral Sections / Phase Breaks in tunnels where a limited system height exists. It is compatible with most cantilivers and catenary systems. It will be delivered with as a complete arc catcher device with all clamping components and messenger wire insulators. Detailed customer related data of the possible site are essential. Minimum system height 370 mm
Maximum system height 620 mm

Material
Stainless steel

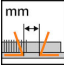
Legend
1) Ø cantelever to specify

Article-Nr.									
690.044.000	150 - 350							16	1



Technical Specifications: **Arc catcher NSL25**

	690.044.000
Arcing horn distance	150 - 350 mm
Commercial specification	
Customs number	85354000
country of origin	CH
Logistic specification	
Kilo / piece	16 kg

